

Warnings and Instructions: Review carefully, proper application is required

⚠ Warning: This device will not prevent or eliminate risk of injury. Do Not Overtighten. If swelling, pain, skin irritation, or an unusual reaction occurs, discontinue use immediately and consult your medical professional.

Care: Hand wash using mild soap. Rinse thoroughly. Air dry only. Do not tumble dry. For single patient use only

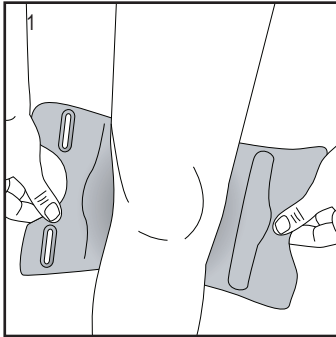

1. Fitting the brace: Place brace behind the knee with the D-rings and patellar flap on the outside of the leg.

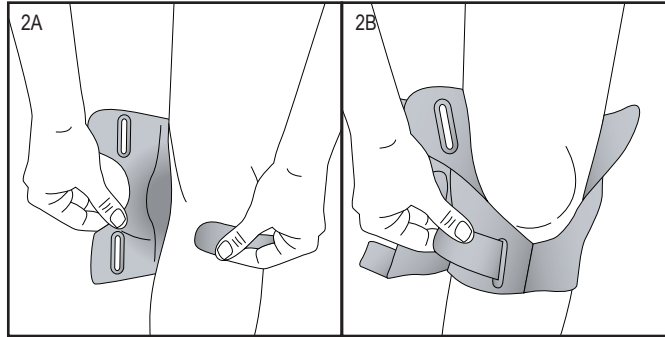

2. Secure the calf section by inserting the tab through the D-ring. Pull tab until the desired fit is achieved. Then secure tab.

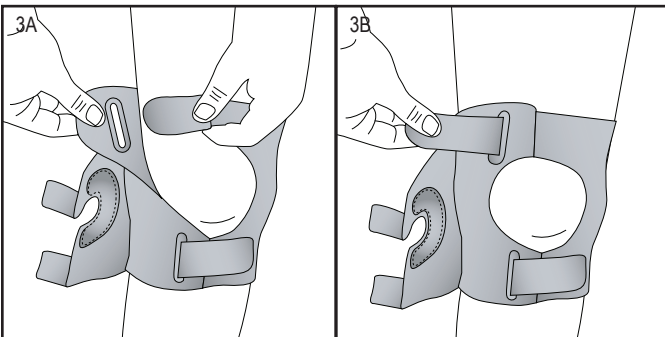

3. Secure the thigh section by inserting the tab through the D ring. Pull tab until the desired fit is achieved. Then secure tab.

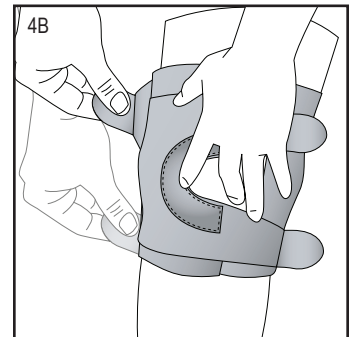
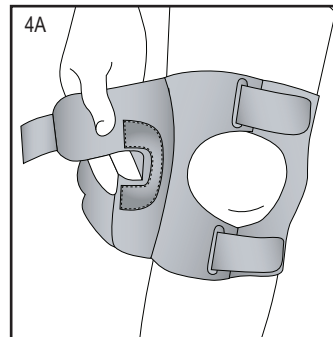

4. Buttress application: Detach the patella flap. Place the buttress in the desired location against the side of the kneecap. Attach base by securing Velcro tabs. This step is only done during initial fitting.

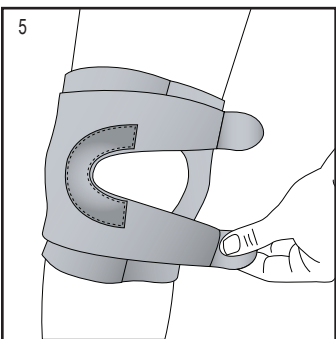

5. Lower patella support: Adjust patella support by pulling the tension straps to the desired tension. Secure tabs.

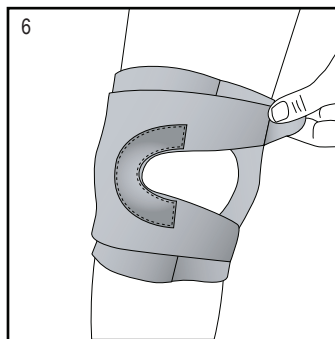

6. Upper patella support: Adjust patella support by pulling the tension straps to the desired tension. Secure tabs.